

## capsule pressure gauges DS 2.5" (63mm)



PED 2014/68/UE

Suitable for extremely low pressure and vacuum measuring, especially when gas and dry air are involved.

### 2.09.1 - MN9 DN63

**Design:** EN 837-3.

**Ranges:** from 0...24 to 0...600 INWC (from 0...60 mbar to 0...600 mbar), vacuum and combined vacuum/pressure (or equivalent units).

**Accuracy class:** 1.6 as per EN 837-3.

**Ambient temperature:** -13...+149 °F (-25...+65 °C).

**Process fluid temperature:** +212 °F; (+100 °C).

**Thermal drift:** ±0,4 %/10 °C of range (starting from 68°F - 20°C).

**Working pressure:** max 75% of FSV.

**Over pressure limit:** 25% of FSV.

**Protection degree:** IP 55 as per EN60529/IEC 529.

**Socket material:** copper alloy, nickel plated.

**Elastic element:** copper alloy.

**Case:** stainless steel.

**Ring:** stainless steel polished, crimped.

**Window:** plastic.

**Movement:** copper alloy.

**Dial:** aluminium, white with black markings.

**Pointer:** aluminium.

**Zero adjustment:** external.

0...60 mbar	-60...0 mbar	-20...40 mbar
0...100 mbar	-100...0 mbar	-40...20 mbar
0...160 mbar	-160...0 mbar	-40...60 mbar
0...250 mbar	-250...0 mbar	-60...40 mbar
0...400 mbar	-400...0 mbar	-60...100 mbar
0...600 mbar	-600...0 mbar	-100...60 mbar
		-100...150 mbar
		-150...100 mbar
		-150...250 mbar
		-250...150 mbar
		-200...400 mbar
		-400...200 mbar

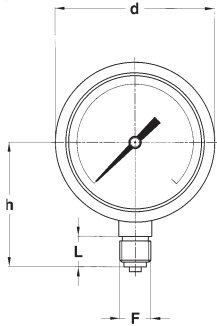

A - LOWER CONNECTION

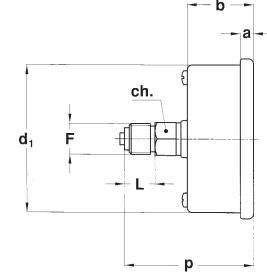
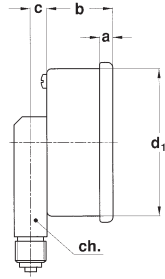

D - BACK CONNECTION

Mounting	DN	F	a	b	c	d	d <sub>1</sub>	h	p	L	ch	Weight : lbs (kg)
Lower	<b>C</b> 2.5" (63 mm)	<b>23M</b> 1/4-18 NPT	0.22 (5,6)	1.10 (28)	0.28 (7)	2.68 (68)	2.46 (62,6)	2.09 (53)		0.51 (13)	0.55 (14)	0.46 (0,21)
Back	<b>C</b> 2.5" (63 mm)		0.22 (5,6)	1.10 (28)		2.68 (68)	2.46 (62,6)		2.12 (53,8)	0.51 (13)	0.55 (14)	0.39 (0,18)

dimensions : inches (mm )

## OPTIONS

<b>B</b> - "U"-clamp, for back connection pressure gauges
<b>E</b> - Front flange, for back connection pressure gauges

## "HOW TO ORDER" SEQUENCE

Section / Model / Case / Mounting / Diameter / Range / Process connection / Options

2 09 1 A C 21M B, E  
D 23M